

STUDIO COORDINATES®

1 3/8" Metal Poles and Traverse Rods
Assemble to Order

METAL FINISHES

Please refer to the product descriptions for available finish numbers.

Studio Coordinates®

006 Black

Shown in Smooth Pole profile

012 Satin Nickel

Shown in Smooth Pole profile

062 Antique Brass

Shown in optional Fluted Pole profile

083 Mahogany

Shown in Smooth Pole profile

110 Satin Brass

Shown in Smooth Pole profile

115 Brushed Copper

Shown in Smooth Pole profile

788 New Provincial

Shown in Smooth Pole profile

• POLES – smooth, 1 3/8" diameter

38" - 66" HD27004 006, 012, 083, 110, 115, 788

66" - 120" HD27006 006, 012, 083, 110, 115, 788

120" - 180" HD27008 006, 012, 083, 110, 115, 788

• POLES – fluted, 1 3/8" diameter

38" - 66" HD27014 062, 110

66" - 120" HD27016 062, 110

120" - 180" HD27018 062, 110

• TRAVERSE RODS – 1 3/8" smooth with plain slides

38" - 66" 18 slides HD27104P 006, 012, 083, 110, 115, 788

66" - 120" 34 slides HD27106P 006, 012, 083, 110, 115, 788

120" - 180" 50 slides HD27108P 006, 012, 083, 110, 115, 788

180" - 270" 82 slides HD27109P 110

• TRAVERSE RODS – 1 3/8" fluted with plain slides

38" - 66" 18 slides HD27114P 062, 110

66" - 120" 34 slides HD27116P 062, 110

120" - 180" 50 slides HD27118P 062, 110

• TRAVERSE RODS – 1 3/8" smooth with decorative ring slides

38" - 66" 18 rings HD27104D 006, 012, 083, 110, 115, 788

66" - 120" 34 rings HD27106D 006, 012, 083, 110, 115, 788

120" - 180" 50 rings HD27108D 006, 012, 083, 110, 115, 788

180" - 270" 82 rings HD27109D 110

• TRAVERSE RODS – 1 3/8" fluted with decorative ring slides

38" - 66" 18 rings HD27114D 062, 110

66" - 120" 34 rings HD27116D 062, 110

120" - 180" 50 rings HD27118D 062, 110

TRAVERSE RODS

- On all traverse rods: mounting brackets, supports, support covers and tension pulleys included
- Clearance 2 1/2" - 5 1/2"
- Depending on rod ordered, slides or rings are included but you must specify on order
 - Slides must specify HD27128 in finish 063 Brass
 - Rings must specify ring style and finish.
 - HD27120 Smooth in 006 Black, 012 Satin Nickel, 110 Satin Brass and 115 Brushed Copper
 - HD27122 Fluted in 062 Antique Brass or 110 Satin Brass
 - HD27126 Grained in 083 Mahogany and 788 New Provincial
- Must specify finials

Fluted Profile



Smooth Profile



STUDIO COORDINATES®

Specialty Brackets

Brackets

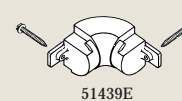

51439E

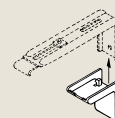

51138

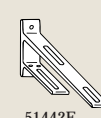

51442E

Brackets per Inch Recommended

38" up to 66"	3 brackets required
66" - 120"	4 brackets required
120" - 180"	6 brackets required

Brackets

Number	Product	Finishes
51439E	90° inside corner elbow with two supports per bag	063 Brass
51138	Support Cover with one per bag	025 White
51442E	Support for Cirrosa and conventional traverse with one per bag	063 Brass

Double Treatments

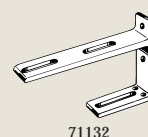

71132

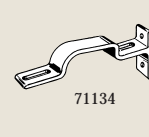

71134

Double Treatments

Number	Product	Return	Clearance	Finishes
71132	Double Bracket	6"-7"	1 1/2" - 3"	006, 012, 062, 086, 110
71134	Double Support	6"-7"	1 1/2"	110



STUDIO COORDINATES®

Decorative 1 3/8" Metal Traverse Rods and Poles

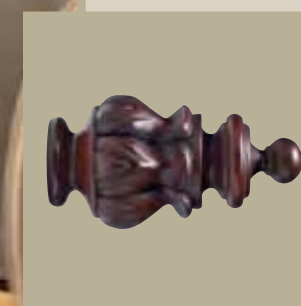

Kirsch Window Fashions ©2005
4110 Premier Drive, High Point, NC 27265
Phone: 1.800.225.1988 • Fax: 1.800.545.2325
www.kirsch.com

A Division of
NewellRubbermaid

F0630004

STUDIO COORDINATES®

Finials (For Use On 1 3/8" Poles and Rods)
Assemble to Order

Finials (For Use On 1 3/8" Poles and Rods)
Assemble to Order

STUDIO COORDINATES®

Rings

STUDIO COORDINATES®

Stock Traverse Rod Sets



HD55557 Rosette
Size: 4 1/2" w x 3 3/8" h x 3 3/8" d
Finishes: 012 (shown), 110
Pole Attachment: Screw On
Material: Resin

HD55564 Terra
Size: 5 1/8" w x 3" h x 2 1/4" d
Finishes: 062 (shown), 115
Pole Attachment: Screw On
Material: Resin



HD27040 Summit
Size: 4 3/8" w x 3" h x 3" d
Finishes: 062, 110, 779 (shown)
Pole Attachment: Plug In
Material: Molded Polymer with Vacuum Metallized Finish

HD27010 Classic Ring w/Eyelet
Inner Diameter: 1 3/4"
Finishes: 006, 012, 062, 083, 110, 115 (shown), 788

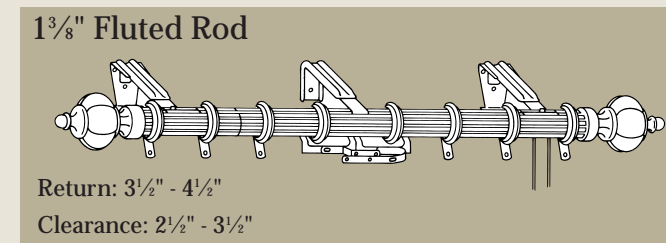
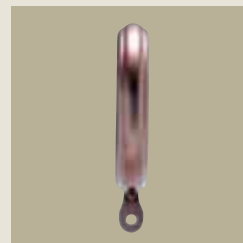

Summit
Finishes: 062, 110
51544C 38"-66", 16 rings, 1 support
51546C 66"-120", 28 rings, 2 supports
51548 100"-180", 42 rings, 4 supports
51540B Extra Rings, 4 ring slides per bag

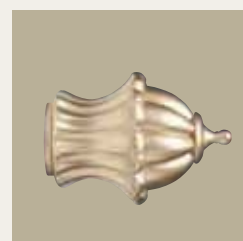

HD55559 Diadem
Size: 4 3/4" w x 3 3/8" h x 3 3/8" d
Finishes: 110 (shown), 788
Pole Attachment: Screw On
Material: Resin

HD55556 Arroyo
Size: 5" w x 4 1/4" h x 1 1/2" d
Finishes: 006, 115 (shown)
Pole Attachment: Screw On
Material: Metal



HD27041 Victoria
Size: 3 3/8" w x 2 1/2" h x 2 1/2" d
Finish: 062 (shown)
Pole Attachment: Plug In
Material: Molded Plastic with Vacuum Metallized Finish

HD27120 Smooth Ring Slides
Finishes: 006, 012, 110 (shown), 115

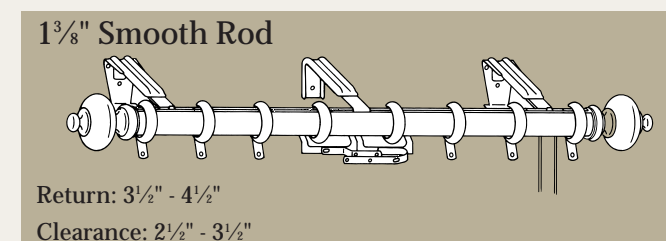
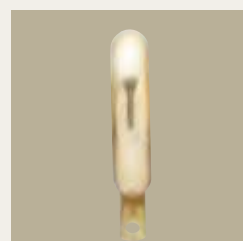

Americana®
Finish: 110
51244C 38"-66", 16 rings, 1 support
51246C 66"-120", 28 rings, 2 supports
51248 100"-180", 42 rings, 4 supports
51240B Extra Rings, 4 ring slides per bag



HD55560 Cheyenne
Size: 5 1/4" w x 3" h x 3" d
Finishes: 083, 788 (shown)
Pole Attachment: Screw On
Material: Resin

HD27049 Scroll
Size: 4 3/8" w x 3" h x 1 1/8" d
Finish: 006 (shown)
Pole Attachment: Screw On
Material: Metal



HD27042 Americana®
Size: 3" w x 2 3/8" h x 2 3/8" d
Finish: 110 (shown)
Pole Attachment: Plug In
Material: Molded Plastic with Vacuum Metallized Finish

HD27122 Fluted Ring Slides
Finishes: 062, 110 (shown)

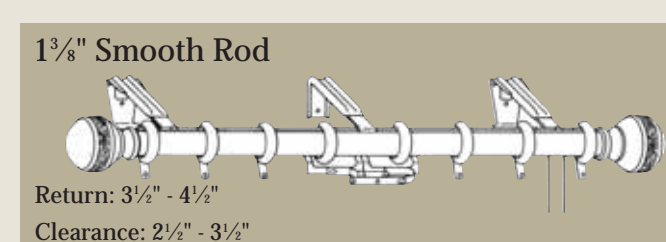
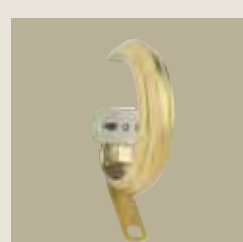

Rosette
Finishes: 110, 012
51314C 38"-66", 16 rings, 1 support
51316C 66"-120", 28 rings, 2 supports
51318 100"-180", 42 rings, 4 supports
51240B Extra Rings, 4 ring slides per bag

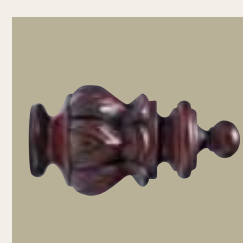

HD55561 Coronet
Size: 5 1/2" w x 3" h x 3" d
Finishes: 083 (shown), 110
Pole Attachment: Screw On
Material: Resin

HD27057 Eye
Size: 6" w x 3 3/8" h x 1 1/8" d
Finish: 012 (shown)
Pole Attachment: Screw On
Material: Metal

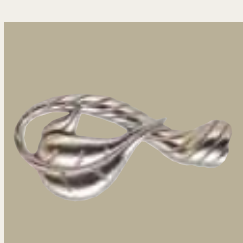

HD27060 Cirrosa®
Size: 1 3/8" w x 1 1/4" h x 4 3/8" d
Finish: 110 (shown)
Pole Attachment: Plug In
Material: Molded Plastic with Vacuum Metallized Finish

HD27126 Grained Rings
Finishes: 083, 788 (shown)

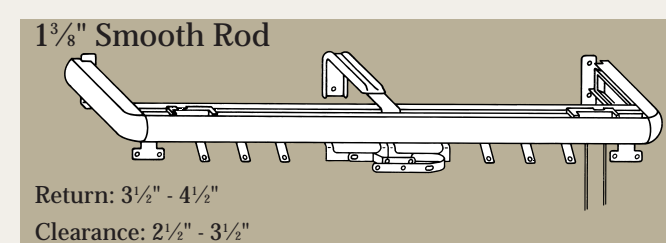
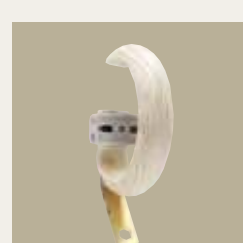

Cirrosa®
Finish: 110
51444C 38"-66", 16 rings, 1 support
51446C 66"-120", 28 rings, 2 supports
51448 100"-180", 42 rings, 4 supports
55540B Extra Rings, 4 ring slides per bag

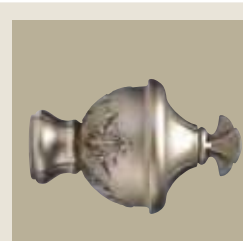

HD55562 Fontana
Size: 5 1/2" w x 3 3/8" h x 3 3/8" d
Finishes: 062 (shown), 083
Pole Attachment: Screw On
Material: Resin

HD27061 Seville
Size: 7" w x 2 3/8" h x 1 1/8" d
Finish: 071 (shown)
Pole Attachment: Screw On
Material: Metal

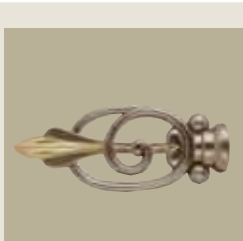

HD27128 Plain Slide
Finish: 063 (shown)

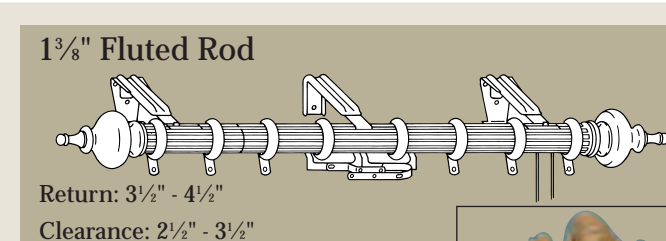

Brentwood
Finish: 086
55544C 38"-66", 16 rings, 1 support
55546C 66"-120", 28 rings, 2 supports
55548 100"-180", 42 rings, 4 supports
55540B Extra Rings, 4 ring slides per bag



HD55563 Camber
Size: 4 3/8" w x 3 3/8" h x 3 3/8" d
Finishes: 062, 115 (shown)
Pole Attachment: Screw On
Material: Resin

HD27044 Diamond Faceted
Size: 2 3/8" w x 2 3/8" h x 2 3/8" d
Finishes: 062 (shown), 110
Pole Attachment: Screw On
Material: Metal/Acrylic



Studio Coordinates® finishes:

006 Black, 012 Satin Nickel, 062 Antique Brass, 071 Pewter/Brass, 083 Mahogany, 110 Satin Brass, 115 Brushed Copper, 779 Satin Brass/New Stone, 788 New Provincial

*All "screw on" finials include a plug kit. These finials may be used with 1 3/8" Wood Trends™ poles.

Studio Coordinates® finishes:

006 Black, 012 Satin Nickel, 062 Antique Brass, 071 Pewter/Brass, 083 Mahogany, 110 Satin Brass, 115 Brushed Copper, 779 Satin Brass/New Stone, 788 New Provincial

*All "screw on" finials include a plug kit. These finials may be used with 1 3/8" Wood Trends™ poles.

* Number of ring slides includes master ring slide.